

PL4714SV

NO.	DESCRIPTION	NO.	DESCRIPTION
1	Inch hex flange bolts	52	Ratchet Wheel L
2	blade washer	53	Rear drive fix plate R
3	2pcs Swing blade	54	Rear drive fix plate L
4	Blade Adapter Assy	55	Ratchet Wheel R
5	Bolt M8×25	56	Outer cover of hub
6	Bolt M8×30	57	Wheel assy.
7	Belt cover	58	Inner cover of hub
8	Screw ST6.3×14	59	Rear drive assy.
9	Bolt M6 ×12	60	Height adjustment ball
10	Nut M6	61	Catcher bottom
11	deck welding assy.	62	Lock washer φ6
12	Hieght Adjustment Rod Spring	63	Rear discharge cover shaft
13	Height Adjustment Rod	64	Rear discharge cover spring
14	R type pin	65	Rear discharge cover dust proof
15	Nut M8	66	Rear discharge cover
16	Bolt M8×16	67	Catcher Top
17	Left handle bracket	68	Catcher Screen
18	petrol engine	69	Foam pipe
19	Outlet pipe	70	Self-propelled Lever
20	Inlet pipe	71	Upper handle
21	"O" ring	72	Lever block
22	Cable Block	73	Bolt M6×30
23	Mulching plug	74	Rope Guide
24	Height Adjustment plate	75	Cap nut M6
25	Left handle bracket	76	Quick fix knob
26	Bolt M8×15	77	Pin
27	Side discharge cover shaft	78	Quick knob lever
28	Side discharge cover spring	79	Knob lever fix
29	Side discharge cover	80	Lower handle
30	Side discharge chute	81	Bolt M8×30
31	Side discharge cover bracket	82	Flat washer φ8×φ16×2
32	Self tapping screw M6×10	83	3# triangle knob
33	Self-lock device base	84	Nut M8
34	Self-lock device spring	85	Cable clip
35	Self-lock device limit	86	5# triangle knob
36	Self-lock device base washer	87	Brake cable
37	screw ST4×14	88	Self-propelled cable
38	Outer cover of hub	89	Cable fix base
39	Wheel assy	90	Brake lever
40	Inner cover of hub	91	Split Washer
41	Front drive bushing	92	Throttle control plastic handle
42	Wave washer φ14.2×φ20.7×0.5	93	Bolt M5x30
43	Front drive assy.	94	Nut M5
44	V belt	95	Cable fix pad
45	Self-propelled spring	96	Throttle control cable
46	Belt limit lever	97	Bolt M5x30
47	GT Transmission	98	Flat Washer φ5×φ10×1
48	Ratchet pin Φ5×17.8	99	Handle control panel
49	Rear drive bushing	100	Governor guard plate
50	Ratchet washer	101	Bolt M6×14
51	Spring washer		

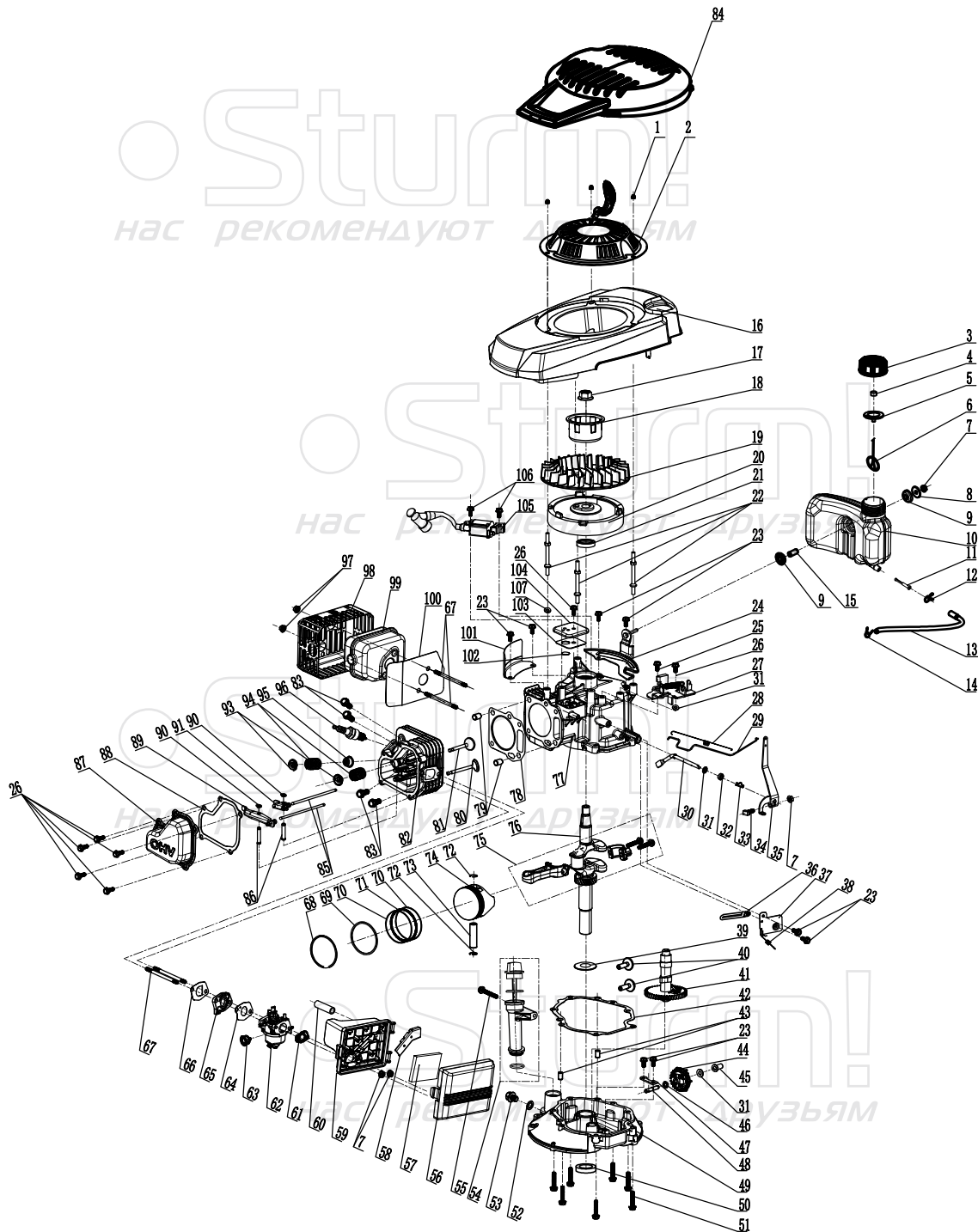

ENGINE FOR PL4714SV

NO.	DESCRIPTION	NO.	DESCRIPTION
1	Nut M6	54	Lubricating Gauge Assy
2	Pull Starter Assy.	55	Bolt M6×50
3	Fuel Tank Cap	56	Air Filter Cover
4	Fuel Tank Cap Sponge	57	Sponge Filter
5	Fuel Tank Cap Seal Gasket	58	Vent Groove Cover Plate
6	Fuel Cap Connect Cable	59	Air Filter Base.
7	Nut M6	60	Exhaust Pipe
8	Washer φ6.5×φ24×1.5	61	Air Filter Paper Pad
9	Tank Vibration Cushion	62	Carburetor Assy
10	Fuel Tank	63	Primer Button li
11	Fuel Pipe Filter Net	64	Carburetor Paper Pad II
12	Fuel Pipe Clip I	65	Intake Pipe
13	Fuel Pipe	66	Carburetor Paper Pad I
14	Fuel Pipe Clip li	67	Dual-Head Bolt M6×94
15	Fuel Tank Installation Bushing	68	Piston Ring I
16	Fan Cover	69	Piston Ring li
17	Nut M14×1.5	70	Guide Rail
18	Starter Hub	71	Bushing Ring
19	Fan	72	Piston Pin Circlip
20	Flywheel Assy	73	Piston Pin
21	Oil Seal	74	Piston
22	Dual-Head Bolts	75	Connecting Rod Assy.
23	Bolt M6×12	76	Crankshaft Assy.
24	Fuel Tank Bracket Assy #2	77	Crankshaft Box Assy.
25	Bolt M6×18	78	Cylinder Head Gasket
26	Bolt M6×14	79	Cylinder Head Locating Pin
27	Detent Assy.	80	Exhaust Valve
28	Throttle Valve Spring	81	Intake Valve
29	Throttle Valve Pushrod	82	Cylinder Head Assy.
30	Rate-Limiting Rocker Arm Shaft	83	Bolt M8×45
31	Washer φ6.2× φ15×0.5	84	Engine Cover
32	Oil Seal	85	Push Rod
33	R Type Pin	86	Valve Rocker Arm Pin Shaft
34	T-Bolt	87	Cylinder Head Cover
35	Throttle Rocker Arm	88	Cylinder Head Gasket
36	Clip	89	Exhaust Valve Rocker Arm Assembly
37	Governor Assembly	90	Split Washer φ5
38	Throttle Control Spring	91	Inlet Valve Rocker Arm Assembly
39	Clockwise Gear Washer	93	Inlet Valve Spring Disc
40	Pin	94	Valve Spring
41	Camshaft Assy	95	Valve Oil Seal Group
42	Crankcase Gasket	96	Spark Plug
43	Pin φ8×14	97	Nut M6
44	Rate-Limiting Gear Assy.	98	Muffler Cover Assy.
45	Sliding Sleeve	99	Muffler Assy.
46	Washer φ6.5×φ12×1	100	Muffler Insulation Cushion
47	Rate-Limiting Gear Shaft Clamp	101	Wind Deflector 1
48	Rate-Limiting Gear Shaft	102	Respirator Valve Plate
49	Crankcase Cover	103	Respirator Head Gasket
50	Oil Seal	104	Respirator Cover Plate Assembly
51	Bolt M6×30	105	Ignition Assy.
52	Oil Drain Bolt Gasket	106	Bolt M6×25
53	Oil drain bolt M10×P1.25×15	107	Washer φ6.5×φ16×3